

DSD HILGERS Stahlbau GmbH

Laacher Weg 5, 56598 Rheinbrohl

Telefon: +49 (0) 2635 963-0

Telefax: +49 (0) 2635 963-385

E-Mail: info@dsd-hilgers.de

Internet: www.dsd-hilgers.de

With precision.
MOVING GREAT THINGS.

- ◉ Multi-ball bearings
- ◉ Steel-/mechanical engineering & assembly
- ◉ Cranes & spreaders
- ◉ Bridge inspection devices
- ◉ Electrical engineering



DSD HILGERS Stahlbau GmbH

Safe stand in motion, heat and heavy loads.

Multi-ball bearings from DSD HILGERS are tried and tested and can be used universally. They guarantee a secure hold in the event of temperature fluctuations, variable expansion paths or heavy loads — and they are absolutely maintenance-free.



0 h

Maintenance effort

Variable mobility
(lengthways / crossways on all sides)

± 120 mm

Agility / Movement

< 2 %

Coefficient of friction

10-2500 kN

Load / Weight bearing capacity

up to 400° C

Temperature resistance

Proven areas of application

- Reactors

Pipelines

Weighing equipment
- Roof rack

Bunker

Electrostatic filter
- Supporting structure

Flue gas cleaning and dedusting systems

Attachment to concrete or steel is possible without any problems. Guided multi-ball bearing can accommodate horizontal loads. These are limited to a max. 10% of the possible vertical loads.

We also create individual special constructions for your specific requirements in terms of temperature, load capacity, expansion path and area of application.

TYP A+C
TYP K

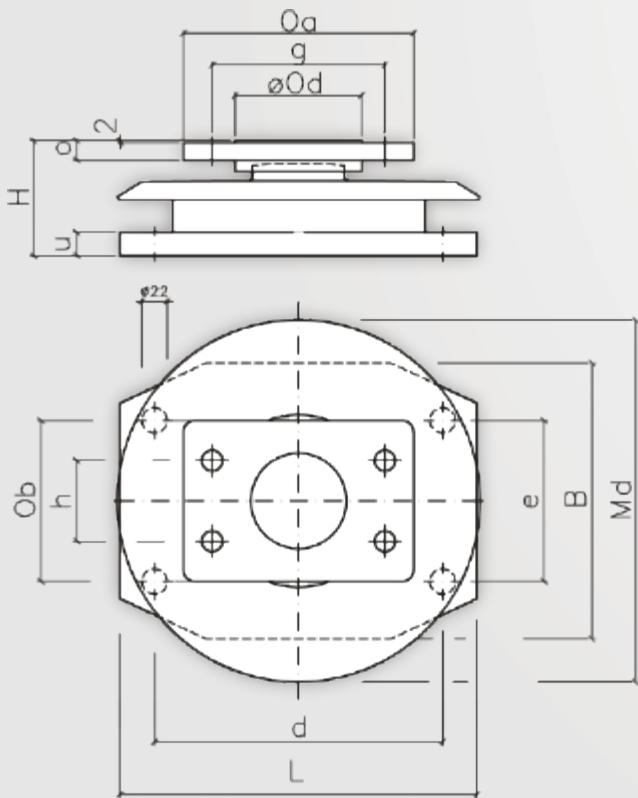

STANDARD BEARINGS (± 25 mm / 120° C)

	TYP K				TYP A+C			TYP A TYP C							
kN	10	50	100	150	200	400	600	850	1000	1500	2000	2500			
L	310	330	360		360			540	590	590	630	630	710	670	810
B	240	260	300		300			400	440	440	480	480	560	530	640
H	100	105	115	128	145	170		215	215	225	235	265	285	285	295
Md	312		342		342			458	458	458	458	518	518	576	576
C	k.A.				k.A.						230				
Od		110			120						160				
Oa		200			200						310				
Ob		140			140						200				
o	12		17		22						27				
g		150			150						220				
h		70			70						80				
d	250	270	300		300			450	500	500	540	540	620	580	720
e		140			140						140				
u		20			20	30	40				32				
ø		22			22						32				
kg	24	25	34	38	44	53	58	132	140	164	187	243	289	311	375
	Steel and Concrete							Steel Concrete							

TYP A
TYP C

